

# Operation & Battery Replacement for LED Equipped Clocks

**IMPORTANT - READ THIS FIRST! \*\*\*PLEASE CHECK TO CONFIRM THIS IS YOUR ITEM BEFORE SERVICE!\*\*\***

***THIS LED BACK-LIT UNIT CONTAINS TWO SEPARATE***

DO NOT push on the glass face when inserting the clock into the holder / mount. Push on the chrome ring or bezel to insert. Make sure clock is inserted all the way into holder / mount before riding or loss and / or damage may result. When the Analog clock loses time or stops or the LED clock no longer illuminates the batteries may be due for replacement. The batteries are accessible from the backside of the clock as outlined below.

**SETTING THE TIME, DATE & ACTIVATING THE LED FUNCTIONS (Fig.1):** (a) The button to activate the LED clock is located at the two o'clock position. Push the button once to illuminate the time for a few seconds. Push the button a second time for date and a third time for seconds. (b) The crown to adjust the analog time is located on the side of the unit at the three o'clock position. To set the time, carefully pull the crown out till it clicks and turn it until the desired time is shown. Push crown back in to the normal position to restart the clock ( *the LED clock and analog clock operate independently and need to be set separately* ). (c) The button to set the LED time & date function is located at the four o'clock position.

**To Set The Digital Functions:** Push the (a) button once to illuminate the time, then immediately push the (c) button to put the unit into set mode. Once put into set mode the display will begin to flash and you may use the (a) button to set the units. Use the (c) button to cycle through the minutes, etc. After you set the unit it will return to its regular operating mode on its own.

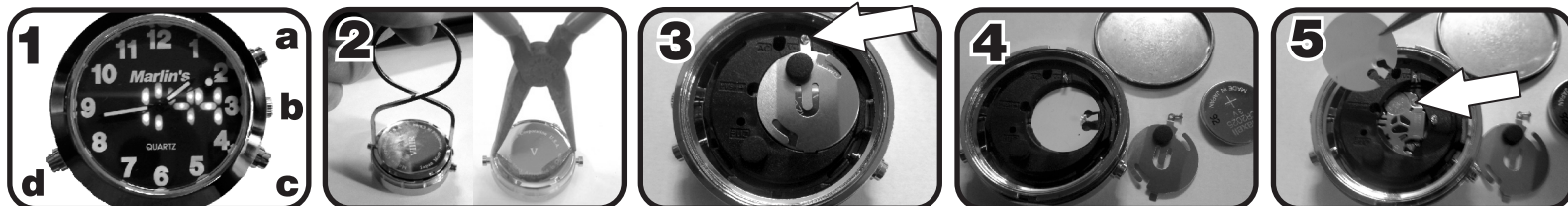

## BATTERY REPLACEMENT:

**CAUTION: DO NOT LIFT MOLDED COMPONENTS OUT OF CASE**

**NOTE: PREFORM THIS OPERATION OVER A TOWEL  
OR MAT SO SMALL PARTS DON'T GET LOST**

**TO REMOVE YOUR CLOCK FROM THE HOLDER / MOUNT:**

Take a sharp object like a pocket knife and put it gently into the departure line between the clock and the holder / mount. Then pry the clock out using a twisting motion so you can get a fingernail under it and lift it out. Perform this operation carefully over a towel as not to lose or drop the clock on the anything and damage it. (Fig.2) Clocks are manufactured with a screw on / off back cover. We sell a tool as shown or use a needle nose pliers or similar tool to easily remove and replace the back cover. Place the tools tips in the slots of the case back and unscrew counter-clockwise. Jewelers also have a tool made specifically for this purpose.

(Fig.3) Clock shown with back cover removed. Tool required to change batteries is a fine tip pocket knife or narrow pointed tool and small phillips head screw driver. Screw to remove #2025 shown at tip of arrow.

(Fig.4) Once screw holding battery strap has been removed, carefully lift the strap, screw out and set aside for re-installation after new battery is installed.

(Fig.5) With the old #2025 battery removed a thin white tray liner is exposed. Remove the thin white liner being careful not to dislodge the tiny spring in the tray, if the spring is dislodged it can simply be replaced into the hole. The #377 analog battery is then exposed and can be pried out for replacement. (Shown with arrow.) Once the old batteries are removed you may replace the batteries with the same or equivalent number battery (Cr2025 & 377) with positive pole (+) facing outward.

## REPLACING ALL COMPONENTS AND SEALING THE CLOCK:

After batteries have been replaced reverse the previous steps to reassemble unit making sure the O-ring seal on the cover is in place.

## FACTS ABOUT THE COMPRESSION RING USED TO HOLD YOUR CLOCK IN THE HOLDER / MOUNT:

When the clock has been installed in the holder / mount for a long time and you remove it from the holder / mount to change the battery or other reason, the rubber compression ring may stay compressed. To avoid a loose fit put a fresh compression ring on the clock ( a spare should have been supplied with the purchase of your new Marlin's item ). Note the compression rings position before removing it, the wide part of the nub molded into the ring should face up and to the out side of the clock.

To rejuvenate or expand the used compression ring back to it's original size, place it in very hot water for a minute or two, then put the ring in cold water and it will bring it back to shape for the next time you need to switch compression rings.

## ITEMS REQUIRED

- Tool to remove back of clock
- Small phillips head screw driver
- A tweezers is helpful
- Batteries needed #377 & #2025

Note: the 2025 is drained based on the number of pushes so it may not need replacement as often as the 377 analog battery.

It is recommended when you take the clock out of the holder/mount to use some isopropyl alcohol and clean the inside rim of the holder / mount were the clock goes to eliminate any dirt or oils that could reduce the gripping power of the compression ring.

## CHROME CARE:

The holder / mount and bezel can be polished and cared for with a quality chrome polish. Your new clock is waterproof, shock resistant and the numbers may glow in the dark if so equipped. The face must be exposed to a light source before you ride to charge and activate the glow in the dark feature.

## TO RE-INSERT YOUR CLOCK OR THERMOMETER INTO THE HOLDER/MOUNT:

You can moisten a paper towel with Windex or similar product, then wipe it on the rubber ring around the clock to help you slide the clock in to the holder. (Allow the Windex or other product to dry completely before riding ) Turn the clock in the position you like and push it in place, push inward on the chrome edges or bezel of the unit, making sure that the rubber ring is not stuck on the edge of the holder / mount, (you may use your fingernail or similar object to make sure the rubber ring is in place properly) and there is no gap so that the unit is firmly in place.

When replacing the clock in the holder, press on the chrome bezel not the crystal / glass.

*Enjoy your Marlin's Product*